

Exchange Partner Information

Name: University of Seoul

Country: Republic of Korea (South Korea)

Primary Contact Persons for Exchange Students			
Main Contact	Contact Person	Responsibilities	Contact Details
exchangeout@uos.ac.kr	Ms. Heewon PARK	Asia, Middle & South America - Agreement & Outbound Short-term Study Abroad Program	Tel: +82-2-6490-6665 Email: kor1hee1@uos.ac.kr
	Ms. Claire Nayoon LEE	Europe & Australia - Agreement & Outbound Seoul International Summer School	Tel: +82-2-6490-6661 Email: imnylee17@uos.ac.kr
	Ms. Hailey Hyein KIM	ISEP & North America - Agreement & Outbound Dual Degree	Tel: +82-2-6490-6658 Email: kimhi610@uos.ac.kr
exchangein@uos.ac.kr	Ms. Jean SONG	All Regions except Asia & ISEP - Inbound Seoul International Summer School	Tel: +82-2-6490-6657 Email: jeanss@uos.ac.kr
	Ms. Juyeon KIM	Asia - Inbound Int'l & GKS Admissions (Undergraduates)	Tel: +82-2-6490-6660 Email: nori14@uos.ac.kr
	Mr. Sangseop EOM	Seoul International Summer School / Seoul Mate Int'l & GKS Admissions (Graduates)	Tel: +82-2-6490-6659 Email: eoms21@uos.ac.kr
	Ms. Jieun KANG	GKS Scholarship / Global Lounge Int'l & GKS Admissions (Undergraduates)	Tel: +82-2-6490-6654 Email: kje0810@uos.ac.kr

Tel : +82-2-6490-6662 || Fax: +82-2-6490-6664 || Useful Websites: <http://global.uos.ac.kr> & <http://www.visitkorea.or.kr>

Address: 163 Seoulsiripdae-ro, Dongdaemun-gu, Seoul, Republic of Korea 02504

Semester Dates

Spring Semester, 2020(E)

Fall Semester, 2020(E)

	Spring Semester, 2020(E)	Fall Semester, 2020(E)
Dorm Check-in (from 3pm)	From February 27, 2020	From August 27, 2020
Orientation	February 28, 2020	August 28, 2020
Classes start / end	March 2, 2020 / June 19, 2020	September 1, 2020 / December 22, 2020
Vacation (Winter/ Summer)	June 22, 2020 – August 31, 2020	December 23, 2020 – February 28, 2021
Exams	Mid-term in April, Final in June	Mid-term in October, Final in December
Dorm Check-out (by 12pm)	June 20, 2020 *extension possible(only monthly) upon request	December 23, 2020 *extension possible(only monthly) upon request
Nomination Deadline	October 15, 2019	April 15, 2020
Application Deadline	October 31, 2019	April 30, 2020
Admission Issue	Early December	Early June
Nomination Process	<ul style="list-style-type: none"> - The international offices of UOS partner universities are required to nominate candidate(s) via the following site: http://global.uos.ac.kr/iice/nomination/write.do - Reference: IICE website (http://global.uos.ac.kr) → For International Students → Studying in UOS → Nomination 	
Application Process	<ul style="list-style-type: none"> - Nominated students are required to complete UOS online application via the following site: http://global.uos.ac.kr/iice/study/prProcess.do - Reference: IICE website (http://global.uos.ac.kr) → For International Students → Studying in UOS → Student Exchange Program → Eligibility & Application Process - What to submit on arrival <ol style="list-style-type: none"> (1) One official photo (3.5cm x 4.5cm, full color with white background) (2) Copy of insurance (3) Certificate of Health (mandatory document for on-campus housing residents and submit to housing office at check-in) 	

All the dates for Academic Year 2020 are **tentative* as of October 16, 2019**. If there is any change, it will be notified accordingly.

*Academic Schedule for 2020 will be confirmed in November, 2019.

Academics

< Language >

Courses given in which language(s)	<p>Mostly Korean, but some of classes be lectured in English</p> <p>* List of the courses offered in English: refer to the IICE website => http://global.uos.ac.kr/iice/study/prEnglish.do</p> <p>* The final course list can be found a month before each semester starts.</p> <p>We cannot guarantee the courses your students would like to take.</p>
Language requirements (i.e. TOEFL scores)	N/A
Language courses	<p>Korean language courses available <u>free of charge</u></p> <p>- 3 levels of Korean Language courses will be offered Beginning Korean, Intermediate Korean, Advanced Korean Language</p> <p>- Specific Korean Language course list will be informed early February and August.</p>

<Graduate School>

Does UOS accept international graduate students to graduate school as non-degree short-term exchange students?	<p><input checked="" type="checkbox"/> Yes <input type="checkbox"/> No</p> <p>* However, all the courses offered at graduate level are taught in Korean. For the graduate students who are not fluent in Korean is strongly advised to be enrolled to undergraduate program. In this case, the student should ask his/her study abroad coordinator at the home university if this option would be accepted according to the university's policy.</p>
----------------------------------------------------------------------------------------------------------------	------------------------------------------------------------------------------------------------------------------------------------------------------------------------------------------------------------------------------------------------------------------------------------------------------------------------------------------------------------------------------------------------------------------------------------------------------

< Others >

Conditions for choosing academic programs	Most of the departments or schools of UOS welcome exchange students. However, it is strongly recommended for exchange students to apply to their field of studies.
Recommended credit points per semester	<p>15 credits</p> <p>* Most courses are equivalent to 3 credits.</p> <p>* 1 credit = 15 class hours</p> <p>* A student should take at least 6 credits and can take up to 20 credits.</p>
Grading System	<p>A+:95-100 A0:90-94 B+:85-89 B0:80-84 C+:75-79 C0:70-74</p> <p>D+:65-69 D0:60-64 F (fail): below 59</p>
Course Registration	<p>UOS Course Registration System (UOSCRS) for international exchange student - http://wise.uos.ac.kr/uosdoc/ucr.UcrIntchTlsnLogin.serv</p> <p>Students are required to do online course registration via UOSCRS and detailed information will be announced early February and early August.</p> <p>* Course List is available only a month before each semester starts (early February/early August). UOS regional coordinators contact to each student as soon as course list completed.</p>

Housing

On-campus Housing	- UOS only secure/guarantee on-campus housing <u>only for those exchange students whose universities secure/guarantee on-campus housing for UOS students.</u> - ISEP students are assigned to stay on-campus housing (only in Residence Hall)
Off-campus Housing	- UOS recommends several off-campus housings to the students (open for all)

*UOS do not secure on-campus housing to all partner universities for dormitory room shortage. The condition for on-campus housing guarantee is as above. Please confirm with your home university coordinator your housing option before complete UOS online application.

<On-campus Housing>

Room Type of Residence Hall	<p>Each room of double occupancy, 15 rooms on each of the 7 floors</p> <ul style="list-style-type: none"> - Shower room, Toilet, and Laundry are shared. - Extension possible during vacations. <p>Fees: 560,000 won/semester + 100,000 won deposit = 660,000 won</p> <ul style="list-style-type: none"> * Fees for vacation (about 2 months): 280,000 won * Application for vacation: right before each semester ends
Room Type of International House	<p>Each unit with 2 rooms / 3 rooms / 5 rooms of single occupancy</p> <ul style="list-style-type: none"> - Living room, Shower room, Toilet, and Laundry are shared. - Extension possible during vacations. <p>Fees: 800,000 won/semester + 100,000 won deposit = 900,000 won</p> <ul style="list-style-type: none"> * Fees for vacation (about 2 months): 400,000 won * Application for vacation: right before each semester ends
Remarks	<p>In both housings, male and female sections are segregated.</p> <p>Allocation will be done on random basis.</p> <p>Curfew between 3 a.m. and 5 a.m.</p> <p>Fees are payable on arrival at UOS.</p> <p>Deposit will be refunded after the fees for usage of facilities are deducted.</p>
How to apply	<p>You will have applied it through the UOS on-line application system.</p> <ul style="list-style-type: none"> * Due to lack of International House rooms, most of exchange students will be arranged at Residence Hall. UOS scholarship recipients are automatically assigned to Residence Hall.
<p>All the fees and the conditions above are for the Academic year of 2019. If there is any change, it will be notified accordingly.</p>	

<Residence Hall – Room type>

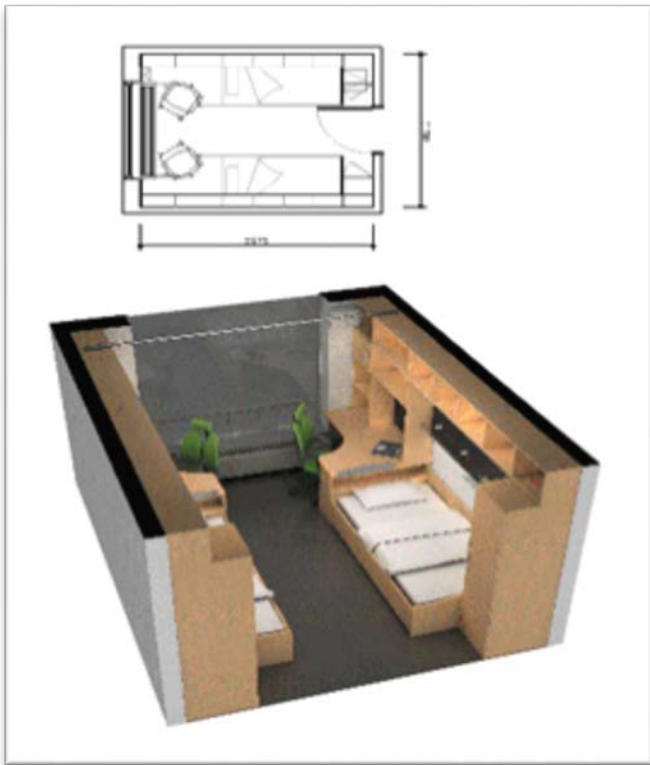

<International House – Room type>



<Off-campus Housing>

URSeoul	<p>Each room of double or triple occupancy, - Single Bathroom, Electric Stove, Refrigerator, Culinary Utensils, AC, Heating System, Washing Machine, Sink, Desk&Chair and Bed.</p> <table border="1" data-bbox="375 448 1492 694"> <thead> <tr> <th rowspan="2">Room</th> <th colspan="2">Single(per room)</th> <th colspan="4">Twin(per person)</th> <th rowspan="2">Triple (per person)</th> </tr> <tr> <th>Standard</th> <th>Suite</th> <th>Standard</th> <th>Superior</th> <th>Deluxe</th> <th>Suite</th> </tr> </thead> <tbody> <tr> <td>Monthly Rent</td> <td>980,000</td> <td>1,030,000</td> <td>610,000</td> <td>650,000</td> <td>690,000</td> <td>720,000</td> <td>495,000</td> </tr> <tr> <td>4-month Rent</td> <td>3,920,000</td> <td>4,120,000</td> <td>2,440,000</td> <td>2,600,000</td> <td>2,760,000</td> <td>2,880,000</td> <td>1,980,000</td> </tr> <tr> <td>Processing& Service Fee</td> <td>300,000</td> <td>300,000</td> <td>300,000</td> <td>300,000</td> <td>300,000</td> <td>300,000</td> <td>300,000</td> </tr> <tr> <td>Deposit (Refundable)</td> <td>200,000</td> <td>200,000</td> <td>200,000</td> <td>200,000</td> <td>200,000</td> <td>200,000</td> <td>200,000</td> </tr> </tbody> </table> <p>No Curfew For more information, please visit to http://urseoul.com/ Just 5 min walk from Seoul Station and 23 min from URSeoul to UOS campus by metro. Inquires & apply : info@urseoul.com</p>	Room	Single(per room)		Twin(per person)				Triple (per person)	Standard	Suite	Standard	Superior	Deluxe	Suite	Monthly Rent	980,000	1,030,000	610,000	650,000	690,000	720,000	495,000	4-month Rent	3,920,000	4,120,000	2,440,000	2,600,000	2,760,000	2,880,000	1,980,000	Processing& Service Fee	300,000	300,000	300,000	300,000	300,000	300,000	300,000	Deposit (Refundable)	200,000	200,000	200,000	200,000	200,000	200,000	200,000
Room	Single(per room)		Twin(per person)				Triple (per person)																																								
	Standard	Suite	Standard	Superior	Deluxe	Suite																																									
Monthly Rent	980,000	1,030,000	610,000	650,000	690,000	720,000	495,000																																								
4-month Rent	3,920,000	4,120,000	2,440,000	2,600,000	2,760,000	2,880,000	1,980,000																																								
Processing& Service Fee	300,000	300,000	300,000	300,000	300,000	300,000	300,000																																								
Deposit (Refundable)	200,000	200,000	200,000	200,000	200,000	200,000	200,000																																								
CMS Inn	<p>Each room of double occupancy, - Private toilet, Air conditional, Refrigerator, TV, Wardrobe, Free WIFI, laundry A. Sing Room(1person) : 950,000 KRW per month B. Sharing Room(2persons) : 550,000 KRW per month (for 1 person) - Deposit 100, 000KRW - Breakfast and all utilities are included No Curfew For more information, please contact to cms.inn.seoul@gmail.com 5 min walk from Hoegi station and 20 min walk from UOS campus. Inquires & apply : cms.inn.seoul@gmail.com</p>																																														
Dwell	<p>Single use- double room, 2PAX use- twin room, 4PAX use- Quadruple room - Private toilet & shower room, Air conditional, Refrigerator, TV, Personal Wardrobe, Free High speed WI-FI, Coin laundry, Free Gym, Roof top, Meeting room, Self-serviced Pantry etc. A. Sing Room(1person) : 1,000,000(900,000+100,000)KRW per month B. Sharing Room(2persons) : 500,000(430,000+70,000)KRW per month/bed (for 1 person) C. Sharing Room(4persons) : 350,000(300,000+50,000)KRW per month/bed (for 1 person) -Minimum 4months stay, exclusive floors for female students -Deposit 1,000,000KRW – Refundable -All utility fees & Management are included -Safety Security system (Entrance, E/V, Each floor), Monthly Resi-life program -1 min walk from Hoegi station(Subway No.1 Line) and 20 min walk from UOS campus. For more information, please visit to www.dwellstudent.co.kr Inquires & apply : jaewoopark@daum.net or SKPE ID : jw.park_18</p>																																														
<p>All the fees above are for the Academic year of 2019. If there is any change, it will be notified accordingly.</p>																																															

Insurance & Certificate of Health

Any insurance packages that students are required to purchase after arrival?	<input type="checkbox"/> Yes <input type="checkbox"/> No <input checked="" type="checkbox"/> No, but proof of prior purchase required
Does Certificate of Health need to be prepared before coming to Korea?	<input checked="" type="checkbox"/> Yes (conditional) <input type="checkbox"/> No * The Certificate of Health is required to be submitted to on-campus housing office for those who stay on-campus housing.

Scholarship

Scholarships offered by UOS for exchange students?	<input checked="" type="checkbox"/> Yes (conditional) <input type="checkbox"/> No If yes, how much is it? (200,000 KRW to 400,000 KRW per month) * Scholarship can be offered on condition that your home university provides similar benefits for UOS students in return. * The recipients should stay in Korea more than 15 days per month to receive this scholarship. * UOS scholarship is not provided during vacations (July&August / January&February). * The recipients should keep their good score at the UOS. If they fail to have at least over 2.5 overall 4.5, we are unable to provide the scholarship.
Scholarship for ISEP students	ISEP students' benefit from UOS - Free on-campus housing (only Residence Hall available) * ISEP students are asked to pay refundable deposit(100,000KRW) on arrival by oneself - Monthly Stipend (400,000 KRW) will be provided as of meal plan * The recipients should stay in Korea more than 15 days per month to receive this scholarship. * Monthly Stipend is not provided during vacations (July&August / January&February) except one-year student.
Others	GKS (Global Korea scholarship) National Institute for International Education (NIIED) is offering GKS for exchange students studying at UOS. The GKS provides one-time settlement fee of 200,000KRW, a monthly stipend of 500,000KRW, and roundtrip airfare.

Others

Average cost of living per semester	700,000 won to 1,000,000 won per month *Including food, local transportation, books, entertainment, etc
UOS buddy system: “SeoulMate”	SeoulMate consists of UOS Korean students will join as volunteers to help you to adjust your life in UOS, Seoul and Korea. SeoulMate will contact you by email about a month before each semester starts.
Airport pick-up	Please refer to the following website. https://www.airport.kr/ap/en/qck/onlResInterTaxiRes.do
Websites for further local information about the city/town and university area	http://www.uos.ac.kr or http://global.uos.ac.kr
UOS’s location in Seoul	10km away from City Hall (North East Seoul)

Information above is as of October 16, 2019 and subject to change. All the changes will be informed accordingly.

